



MM2012D SERIES ~ Wire Wound Chip Common Mode Chokes



FEATURES

1. Small size and low profile.
2. High common mode impedance items can be used considering noise level & signal frequency.
3. Suitable for differential signal line like USB3.0
4. Lead is not contained in the products.
5. Cut-off frequency is up to 7.5GHz
6. Characteristics impedance is matched for 100Ω , which is set for many differential interfaces, and can suppress unnecessary reflection components

PART NUMBERING SYSTEM

MM	2012D	—	900	—	LF
TYPE	DIMENSIONS		IMPEDANCE		LEAD FREE

SHAPES AND DIMENSIONS

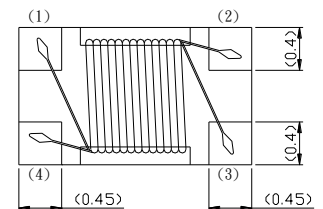
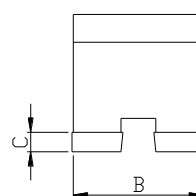
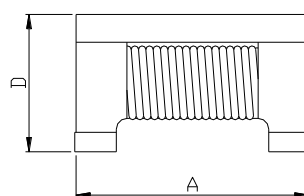
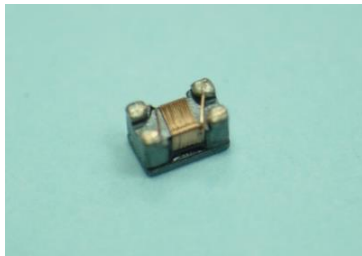

UNIT : mm

A=2.02±0.2 B=1.2±0.2 C=0.4Max. D=1.2±0.2

SPECIFICATION TABLE

PART NUMBER	IMPEDANCE (at 100MHz/20 degree C) (Ω)	RATED CURRENT (mA)	DCR (Ω) (Max)	RATED VOLTAGE (Vdc)	INSULATION RESISTANCE (M Ω)	Cut-off Frequency (GHz)
MM2012D-120	12±30%	420	0.25	50	10 min.	7.5 Typ
MM2012D-240	24±25%	420	0.25	50	10 min.	7.5 Typ
MM2012D-250	25±25%	420	0.25	50	10 min.	7.5 Typ
MM2012D-320	32±25%	400	0.25	50	10 min.	7.5 Typ
MM2012D-600	60±25%	300	0.30	50	10 min.	7.5 Typ
MM2012D-900	90±25%	300	0.30	50	10 min.	7.5 Typ

Operating Temperature Range : -25°C to 85°C



MM2012D SERIES ~ Wire Wound Chip Common Mode Chokes



PACKAGING SPECIFICATION

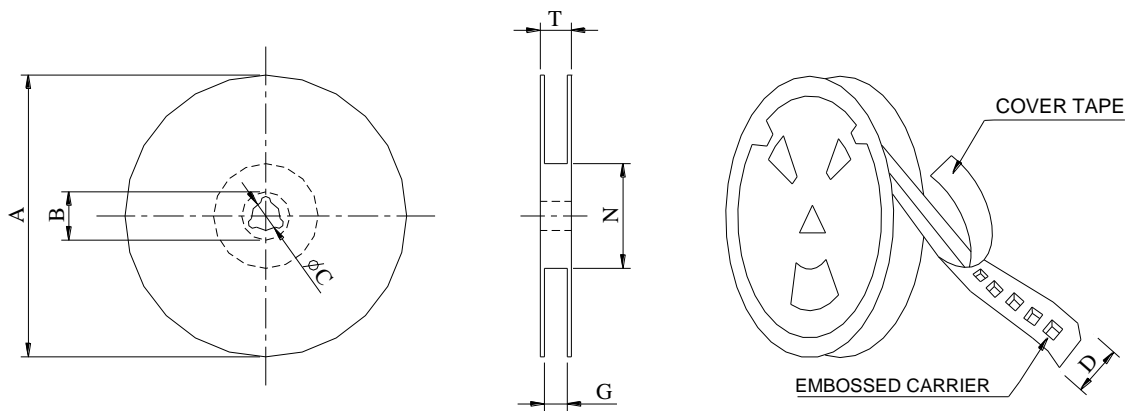

*CARRIER TAPE WIDTH : D

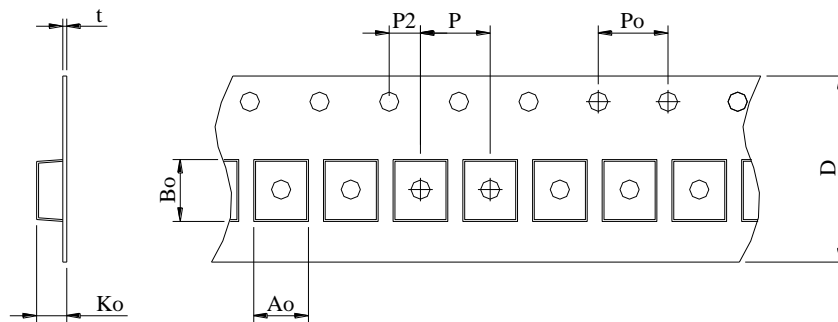

SERIES	STAYLE	Q'TY (PCS)	DIMENSIONS (m/m)								
			A	Ao	Bo	Ko	t	N	P	Po	T
MM2012D	178	2000	178	1.5	2.25	1.7	0.24	60	4	4	12



MM2012D SERIES ~ Wire Wound Chip Common Mode Chokes



Curve for

MM2012D-120-LF

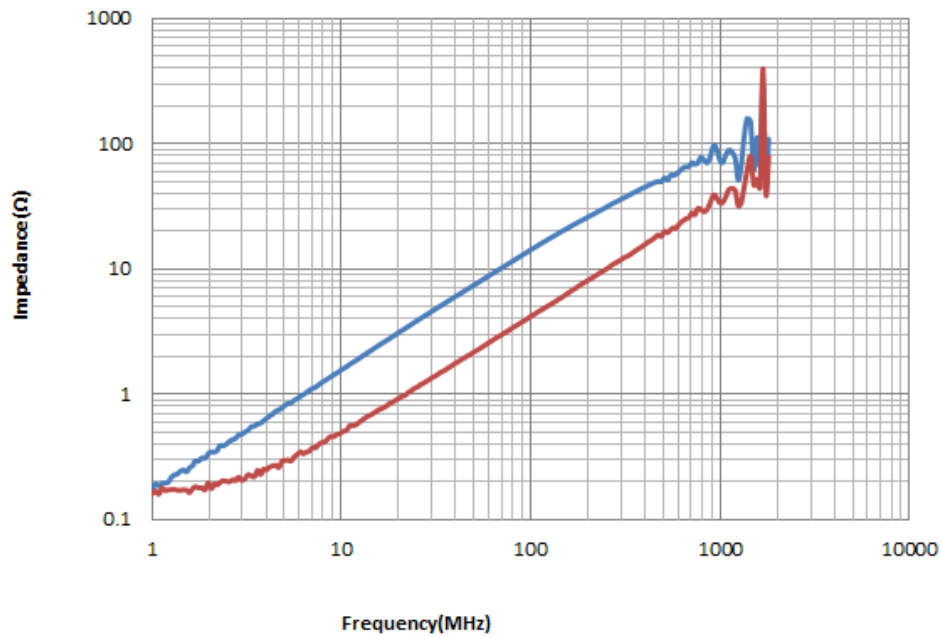

Curve for

MM2012D-240-LF

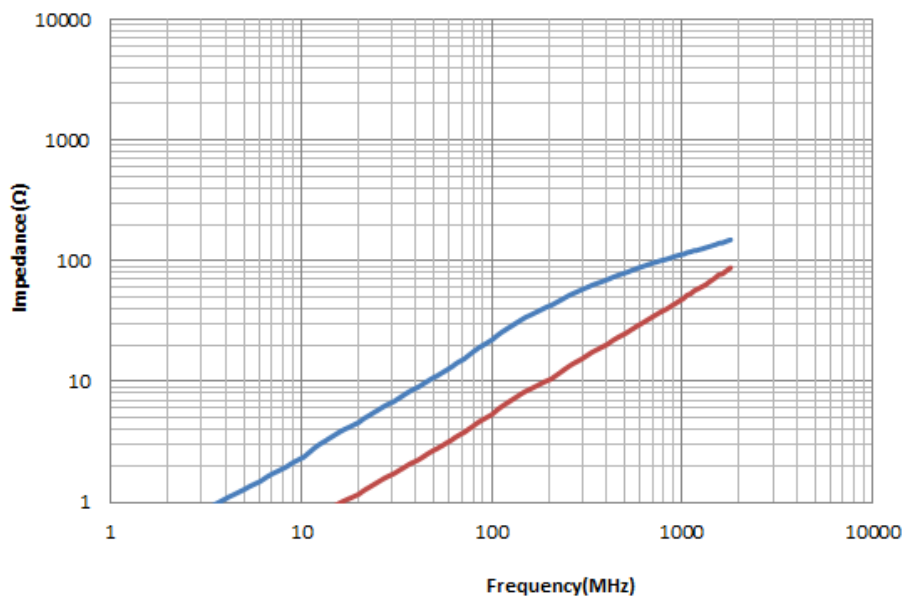



MM2012D SERIES ~ Wire Wound Chip Common Mode Chokes



Curve for

MM2012D-250-LF

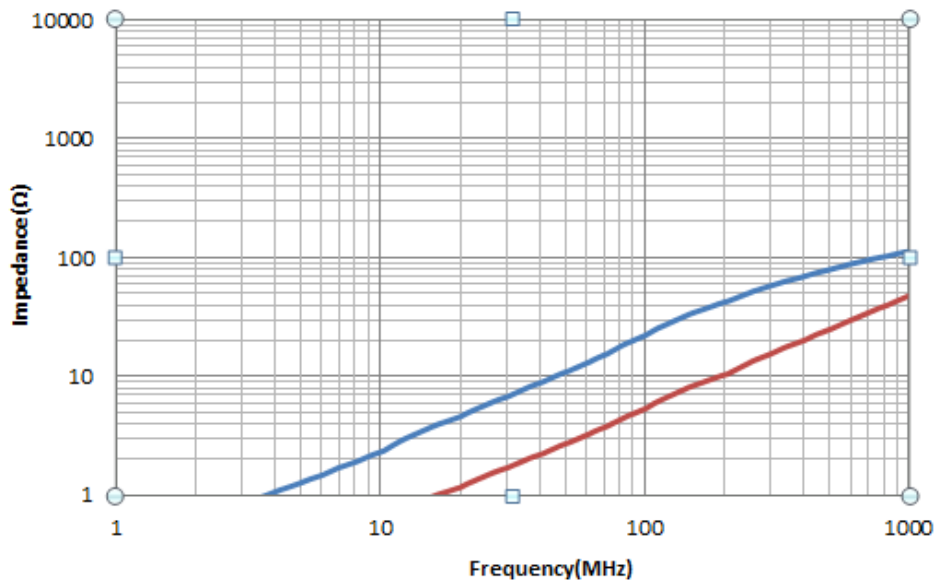

Curve for

MM2012D-320-LF

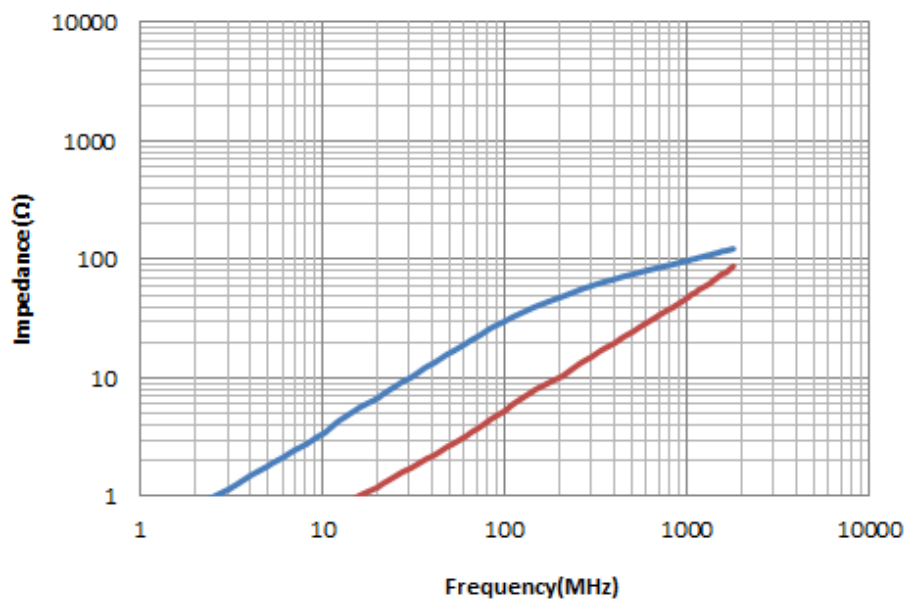



MM2012 SERIES ~ Wire Wound Chip Common Mode Chokes



Curve for

MM2012D-600-LF

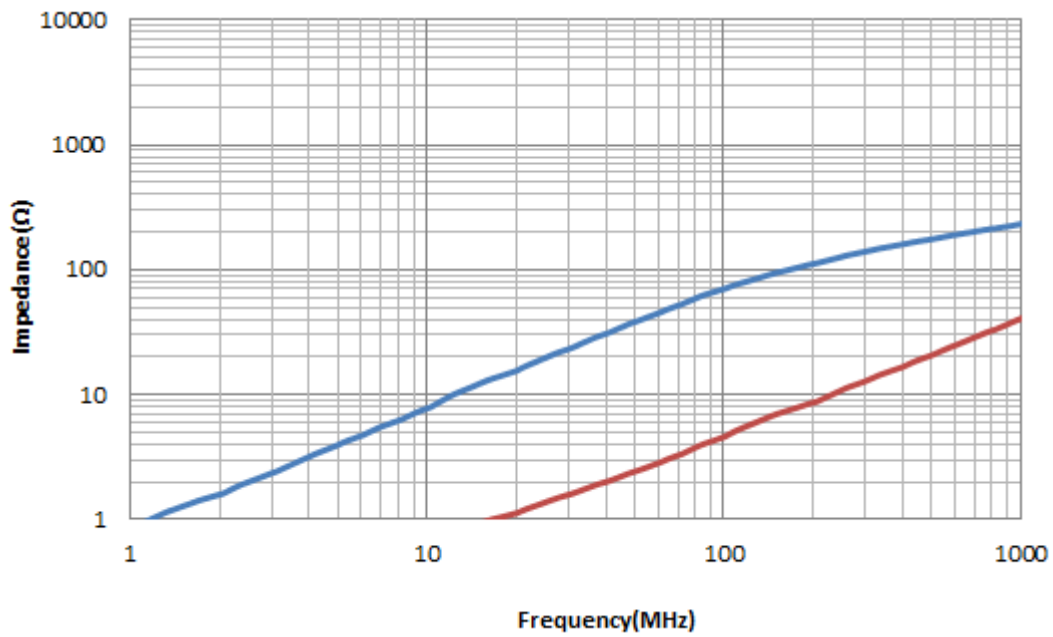

Curve for

MM2012D-900-LF

