



High Current SMD Common Mode Choke ~

SMM TYPE



RoHS Compliant

PART NUMBERING SYSTEM

SMM	1 2 0 6	—	1 0 2	—	LF
TYPE	DIMENSIONS		IMPEDANCE		LEAD FREE

SHAPES AND DIMENSIONS

UNIT : mm

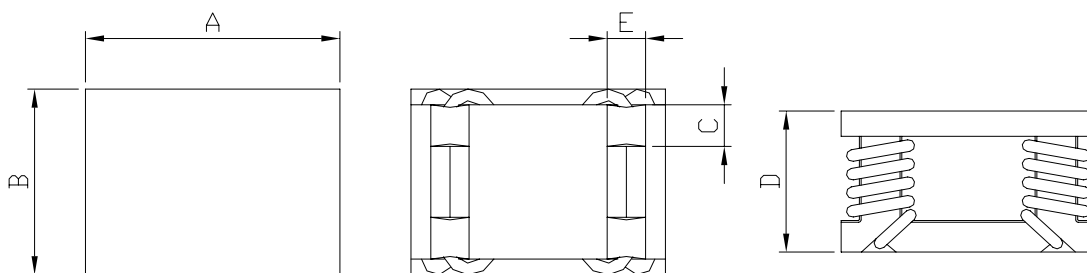

DIMENSIONS (UNIT : mm)

PART NUMBER	A	B	C	D	E
SMM1206	12.0±0.30	10.0±0.30	1.5 Ref.	6.0±0.30	2.0 Ref.
SMM1005	10.0±0.30	8.0±0.30	1.5 Ref.	5.0±0.30	1.8 Ref.
SMM7530	7.5±0.30	6.0±0.30	1.5 Ref.	3.0±0.30	1.5 Ref.
SMM5050	5.0±0.30	8.5±0.30	1.5 Ref.	5.0±0.30	1.0 Ref.
SMM4616	4.6±0.30	5.5±0.30	1.0 Ref.	1.6±0.30	0.5 Ref.



High Current SMD Common Mode Choke ~

SMM TYPE



RoHS Compliant

FEATURE :

- Suitable for Large rated current .
- Wide band and sharp impedance available .
- Ideal for high impedance common mode noise
- Application for a preventive measure against noise terminal voltage and power supply noise in TV , VCR units, SW power supplies , NC machines , PC systems .

SPECIFICATION TABLE

PART NUMBER	IMPEDANCE at 50MHz (Ω)	RATED CURRENT (mA)	DCR ($m\Omega$) (Max)	RATED VOLTAGE (Vdc)	INSULATION RESISTANCE (Ω)min
SMM1206-801-LF	800min.	5000	25.0	50	10M
SMM1206-102-LF	1000min.	5000	35.0	50	10M
SMM1206-122-LF	1200min.	5000	45.0	50	10M
SMM1005-701-LF	700min.	4000	40.0	50	10M
SMM1005-901-LF	900min.	4000	45.0	50	10M
SMM7530-601-LF	600min.	2000	45.0	50	10M
SMM7530-701-LF	700min.	2000	50.0	50	10M
SMM5050-202-LF	2000min.	2500	75.0	50	10M
SMM4616-151-LF	150min.	2000	60.0	50	10M
SMM4616-351-LF	350min.	2000	70.0	50	10M

- Operating temperature range -40°C to $+85^{\circ}\text{C}$,
- Electrical specifications at 20°C .