

Radial Power Inductors - RCB1419U SERIES



PART NUMBERING SYSTEM

RCB	1419U	—	251K	—	LF
TYPE	DIMENSIONS		INDUCTANCE		LEAD FREE

U : UL Tube

P : PET Tube

SHAPES AND DIMENSIONS

UNIT : mm

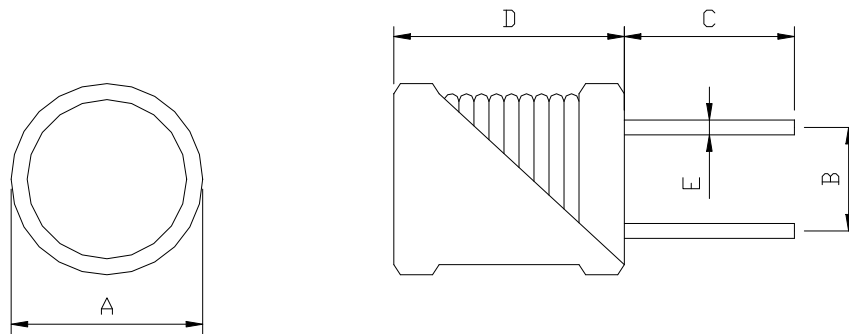

A= 16.0 Max. , B= 8.0±0.5 , C= 15.0±5.0 , D= 22.0 Max. , E= 1.0 Ref.

STRUCTURAL DIAGRAM :

COMPONENT	MATERIALS
1.Core	Ferrite core
2.Wire	Polyurethane enameled copper wires
3.Lead wire	Tinned copper wires
4.Tube	Heat shrinkable tube, PET or UL
5.Glue	Epoxy resin



Radial Power Inductors - RCB1419U SERIES



SPECIFICATION TABLE

PART NUMBER	INDUCTANCE (μ H)	DCR ($m\Omega$) (max)	IDC (A) (max)	TEST FREQ. (Freq.)
RCB1419-100M-LF	10	24	5.0	1KHz
RCB1419-250K-LF	25	40	4.0	1KHz
RCB1419-500K-LF	50	60	3.0	1KHz
RCB1419-101K-LF	100	90	2.0	1KHz
RCB1419-251K-LF	250	180	1.5	1KHz
RCB1419-501K-LF	500	400	1.0	1KHz
RCB1419-102K-LF	1000	800	0.7	1KHz

1. Inductors Tolerance : K = +/-10% ; M= +/-20%
2. Operating temperature range -40°C to +125°C
3. Electrical specifications at 25°C